



Welcome!

At **Bethany Home**, we strive to create the most enjoyable retirement living experience possible. We deliver quality and value in every service we provide and work to maintain and improve the living environment in a compassionate Christian atmosphere. **Bethany Home** Association offers the confidence of over 100 years of senior living experience and serves all varieties of resident needs.

Located in Lindsborg, Kansas, the home is a social ministry of the Central States Synod of the Evangelical Lutheran Church of America. The campus includes a 100-bed skilled nursing facility, 20 assisted living apartments and 49 independent living units. **Bethany Home** Association has a mission of creating a positive Christian environment and delivering Christ-centered care to all residents and guests. Bethany Home has a long and storied history with many changes and a dedication to serving the people of Lindsborg and the surrounding communities.

Whether you, or a loved one, are seeking independent housing options, assisted living services rehabilitation, short or long-term care, **Bethany Home** can help! We understand the difficulty in the decisions you and your family face and will help you plan the best individualized care for your loved one.

The health care center currently holds a four-star rating by the federal Center for Medicare & Medicaid Services and is endorsed by the U.S. Department of Veterans Affairs.

A photograph of the Bethany Home building, a large, multi-story brick structure with a covered entrance. In the foreground, there is a sign that reads "BETHANY HOME".

*Celebrating life's journey
together in God's love.*

321 N. Chestnut • Lindsborg, KS 67456
Phone 785-227-2334 • Fax 785-227-3138
www.bethanyhome.com

Bethany Home

The Bethany Home Association of Lindsborg, Kansas is first and foremost a Christian Home with a Christ centered atmosphere. The basic philosophy of Bethany Home is to continue the Christian Ministry of caring as done by our Lord and Master, Jesus Christ.

MISSION STATEMENT

Celebrating life's journey together in God's love.

VISION STATEMENT

Bethany Home is a vibrant, inclusive community where individuals receive the support needed to thrive and reach the highest level of independence attainable in a compassionate Christian environment. Highly trained, caring professionals provide peace of mind through thoughtful, personalized service and care, embracing innovation, forward thinking stewardship, and market-leading practices.

APPLICATION POLICY

An application for admission to Independent Living, Assisted Living and/or the long-term care center must be completed and returned to Bethany Home, accompanied by a **\$35.00 per person** non-refundable check. The applicant is encouraged to have a personal meeting and/or tour of the facilities. The Admissions Committee will review the application, with priority placement according to level of need or in order of the date on the application.

ADMISSIONS POLICY

An admission fee will be charged at the time of admission to assisted living or long-term care to cover costs for individual record and room preparation. Bethany Home's admission fee varies depending on the resident's payment source.

Once accepted for admission to assisted living or long-term care, residents and/or their families may request a face to face meeting prior to the admission date. Payments for room, board and personal care begin on the date of admission and are payable one month in advance. The payment period runs on a calendar month.

Should the resident be discharged and return to the facility within 12 months, this fee will not be charged again. If the resident is discharged and returns to the facility after 12 months, an admission fee will apply.

Admission fees will not be charged due to a change in the resident's level of care. For example: A resident moving from assisted living to long-term healthcare will not be charged another admission fee.

Contact Information

Bethany Home Association

321 N. Chestnut
Lindsborg, KS 67456

785-227-2334

Ext.

Kris Erickson

111

CEO

Patricia Roraback

110

Office Manager

Stephaney Scott

121

Dietary Manager

Bethany Home Kitchen

Dining Reservations

785-227-2846

Thomas Nichols

123

Activity Director

Delwin Koons

125

Maintenance

Andrea Johnson

126

Human Resources

Phil Hett

133

Interim Chaplain

Anne Anderson

140

Social Services, Admissions

Jennifer Cantrell

142

Marketing Director

Marilyn Spohn

146

Billing/Independent Living

Sara Anderson

159

Director of Nursing

Wendy Johnson

182

Skilled Services

Bethany Home Assisted Living

785-227-8331

Skylar Hanson, RN Operator

Assisted Living

Daily activities like housekeeping, meal planning, cooking, and home maintenance become more difficult with time. **Bethany Home Assisted Living** can remove daily burdens so you can enjoy doing the things you want to do!



Bethany Home Assisted Living is the ideal solution for those who need some attendant care or supervision but still have the ability to maintain their own activities of daily living. Spacious and bright apartments are handicap accessible and offer private bedrooms and bathroom, modern kitchenettes with microwave, refrigerator and granite countertops.

Monthly rent includes the following:

- ◆ Private apartment & Bathroom with zero-entry walk-in shower
- ◆ Personalized Care Plan
- ◆ Professional caring staff
 - ◆ 24 hour access to Certified Medication Aides
 - ◆ Licensed Nurses available 24/7
- ◆ Personal Care Assistance*
- ◆ Ongoing medication management & health monitoring*
- ◆ Three nutritious meals daily served restaurant style with flexible menu options and between meal snacks
- ◆ On-site Physical and Occupational Therapy*
- ◆ Weekly Housekeeping & Linen services
- ◆ All utilities - except cable & Phone service
- ◆ On site storm shelter/safe room
- ◆ Emergency Response System / Call lights in bedrooms & bathrooms
- ◆ Transportation services*
- ◆ Programs, events & outings*

*Additional fees may apply for some services



821 E. Swensson • Lindsborg, KS 67456
Phone 785-227-8331 • Fax 785-227-8332
www.bethanyhome.com

Assisted Living

STUDIO APARTMENT

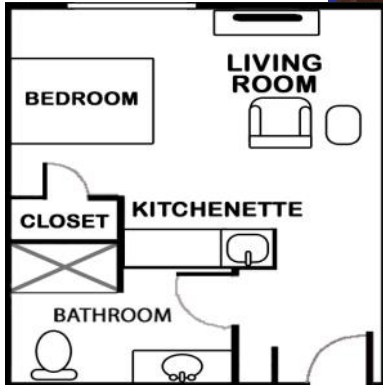

18'6" X 24'
450 Sq. Feet

Full bath,
ample storage,
TV, wireless internet

1 BEDROOM APARTMENT



22'6" X 24'
550 Sq. Feet

Bedroom, separate
living and dining space,
Kitchenette, Full bath, TV,
wireless internet



2 BEDROOM APARTMENT

41' X 24'
1000 Sq. Feet

2 Bedrooms, separate living and dining space,
Kitchenette, 2 Full baths, TV, wireless internet

Skylar Hanson, RN, Assisted Living Operator

821 E. Swensson • Lindsborg, KS 67456

Phone 785-227-8331 • Fax 785-227-8332

www.bethanyhome.com



Celebrating life's journey together in God's love.

Fact Sheet

Bethany Home Assisted Living opened March 25, 2014.

There are twenty apartments in the facility; four 2-bedroom apartments, eight 1-bedroom apartments and eight studio apartments. If needed, a 2-bedroom suite can be created by utilizing an adjoining door between a studio and a 1-bedroom apartment (limited options available).

The Assisted Living is staffed at all times by Certified Medication Aide(s) (CMA). A Licensed Practical Nurse (LPN) is in the facility Monday through Friday during business hours and is on call 24/7. A Registered Nurse (RN) is also available throughout the week and on call 24/7. Staff provide monthly vital signs checks and weight checks free of charge. Additional nursing services may be purchased, as necessary.

Rent at the Assisted Living includes three meals per day (cooked in-house), weekly apartment cleaning, and linen changes. All utilities are paid except personal phone services and cable TV programming.

Additional nursing services are available, based on resident need/preference and may include: medication set-up or management/administration, pacemaker checks, assistance with showering, nail care, blood sugar monitoring, personal laundry service, whirlpool baths, and cueing/reminders for activities of daily living (ADLs). Services are purchased on a "point" system; a resident may have up to 3 points with no additional charge. There are three point levels, with incremental increases in charges for additional services needed.

Transportation within 25 miles of the facility is free of charge. The city of Lindsborg 'Dala bus' provides transportation within a 7 mile radius and will pick up at the Assisted Living. Residents may schedule trips via the Dala bus as needed, Monday through Friday. Residents may also opt to have their families (or staff, depending on availability) assist with transportation or drive their own vehicles, if able.

Criteria that must be met to be able to live in an Assisted Living Facility:

- ◆ No ongoing condition requiring a two-person transfer
- ◆ If mobility is an issue, the resident must be able to exit the building without need for total assistance.
- ◆ If incontinent, the resident must be able to participate in management of the incontinence.
- ◆ No ongoing skilled nursing need, requiring 24/7 nursing intervention
- ◆ No behavioral symptoms that exceed manageability or require use of a restraint.

Medicare benefits are available under outpatient or part B benefits. Hospice services will require family or Hospice staff support per the individual's need and may require a more intensive level of care, such as our long-term care facility.

Currently, Medicaid or HCBS are not funding sources for our Assisted Living, however some long term care insurances do provide funding, if a physician can support the need for this level of care. Private resources are our main source of payment.

Bethany Home Assisted Living

Admission Checklist

Rooms at Bethany Home Assisted Living are unfurnished; you may bring any furniture you like. We will supply each apartment with a microwave and small refrigerator. Any other appliances will need to be approved by the Operator.

Bethany Home will need copies of your **Durable Power of Attorney (DPOA)** paperwork for both **Health** and **Financial** appointments as well as copies of your **Living Will / Advanced Directives**.

The office will need a copy the front and back of your cards:

- a. Social Security
- b. Medicare
- c. Insurance card(s)

If you have a Long-Term Care (LTC) insurance policy you will need to contact your agent to help you file a claim.

Please let us know the name and contact information for your **Primary Care Physician**. If Bethany Home Assisted Living is managing your care and medications, please report any future doctor appointments to the nursing staff.

Bring ALL of your **medications** with you. (Prescription and over the counter) If the facility nurses will be managing your medications please see the facility nurse or operator.

The nurse or operator will complete an assessment for those who are self-managing medications and provide a lock box for the medications. Only residents and those they assign (family member or trusted individual) will have a key and access to the lock box.

The Assisted Living Nurse or Operator will complete a Functional Capacity Screen that identifies areas of independence and areas of need to develop an accurate **Negotiated Service Agreement** and **Healthcare Service Plan**.

If you leave the building and grounds, we ask that you sign IN/OUT in the notebook located at the welcome desk by the front door.

You will be assigned a **mailbox** upon move-in (Located near the front door)

Mail can be forwarded to you at **821 E. Swensson, Lindsborg, KS 67456**

If you want a landline **phone** in your room, please contact a staff member or IT manager for more information.

All rooms are **cable** ready. Bethany Home will provide a mounted flat screen TV in every room. Cable is at an additional cost.

On the day of move in, please meet with Skylar Hanson or a business office representative to review the Resident Agreement, facility policies and develop a Negotiated Service Agreement and Healthcare Service Plan.

Renter's Insurance is required for all residents of Bethany Home Assisted Living.

Extension cords are allowed in resident apartments, but must be approved by the operator.

You are welcome to hang pictures, art, etc. and if you would like help, please ask. We don't want anyone getting hurt so we will help move furniture around as needed.

Bethany Home follows the Kansas State regulations with a 'no tipping' policy. This means that staff are not allowed to individually accept gifts either in money or product. Tipping can jeopardize a license and career. A sincere, 'Thank you' is always appreciated!

If moving from a Bethany Home cottage, please alert Marilyn Spohn. (785-227-2334 x 146)

Please contact us with any other questions you may have.